

Victoria Quarter Site Plan

Boundary of planning application (16/7601/FUL) shown in red

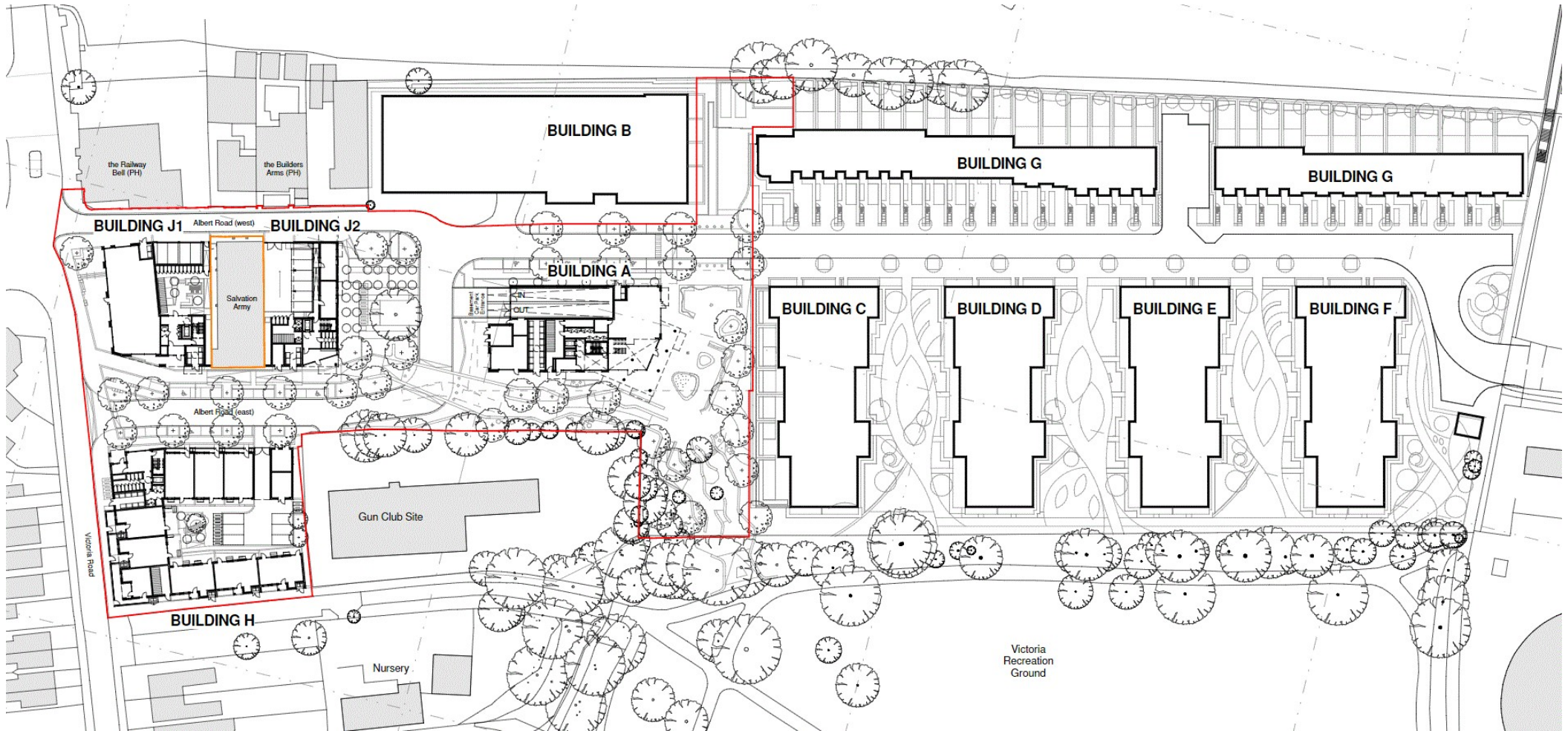

Notes:

Buildings B, C, D, E, F, & G are part of the already consented scheme and are NOT part of this planning application.

Within the red boundary:

Building A has been redesigned from the consented scheme and has increased from 6 to 8 storeys.

Building J2 was previously J on the consented scheme and has increased from 2/3 to 5 storeys.

Building J1 was previously a smaller site designated H on the consented scheme and has increased from 2/3 to 4 storeys.

Building H was not previously part of the development site and replaces three 2 storey houses & Burlington Coachworks with a 5 storey building.

Updated To
Show Feb 2017
Amended Plan